

ARP 50° 06' 03" N 014° 15' 36" E    RUZYŇNĚ TWR 118,100 121,500    RUZYŇNĚ GROUND RUZYŇNĚ DELIVERY 121,900 120,050    AD ELEV 1247 ft / 380 m    **AERODROME CHART - ICAO**    **PRAHA/Ruzyně**

RWY	DIRECTION	THR	BEARING STRENGTH
06	062°	50°06'06,61"N 014°13'34,68"E	PCN 62/R/B/X/T exceeding is allowed by airport operator
24	242°	50°06'57,42"N 014°16'24,12"E	
12	124°	50°06'28,84"N 014°14'43,32"E	PCN 62/R/B/X/T exceeding is allowed by airport operator
30	304°	50°05'25,68"N 014°16'54,02"E	
04	034°	50°05'15,77"N 014°16'00,06"E	PCN 45/F/B/X/T
22	214°	50°06'10,50"N 014°17'04,00"E	
TAXIWAYS		TWY L, M TWY P other TWYS	PCN 50/R/A/X/T PCN 40/F/D/X/T PCN 60/R/B/X/T
TOUCHDOWN AND LIFT-OFF AREAS		BEARING STRENGTH AS TWY	

↑  
VAR 3°E 2013  
ANNUAL RATE OF CHANGE +7"  
ELEVATIONS IN ft / m  
DIMENSIONS IN m  
BEARINGS ARE MAGNETIC

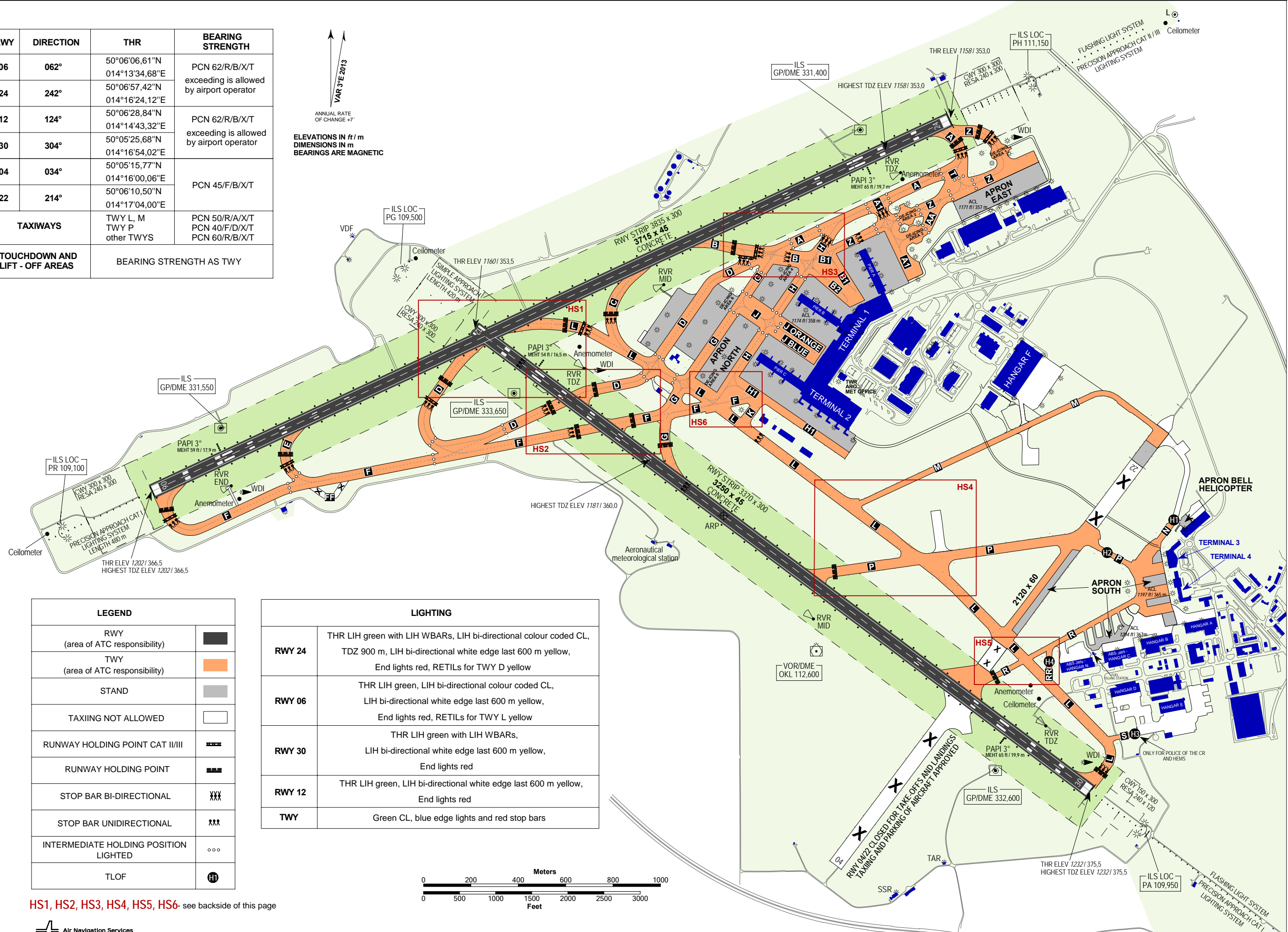

LEGEND	
RWY (area of ATC responsibility)	
TWY (area of ATC responsibility)	
STAND	
TAXIING NOT ALLOWED	
RUNWAY HOLDING POINT CAT II/III	
RUNWAY HOLDING POINT	
STOP BAR BI-DIRECTIONAL	
STOP BAR UNIDIRECTIONAL	
INTERMEDIATE HOLDING POSITION LIGHTED	
TLOF	

LIGHTING	
RWY 24	THR LIH green with LIH WBARS, LIH bi-directional colour coded CL, TDZ 900 m, LIH bi-directional white edge last 600 m yellow, End lights red, RETILs for TWY D yellow
RWY 06	THR LIH green, LIH bi-directional colour coded CL, LIH bi-directional white edge last 600 m yellow, End lights red, RETILs for TWY L yellow
RWY 30	THR LIH green with LIH WBARS, LIH bi-directional white edge last 600 m yellow, End lights red
RWY 12	THR LIH green, LIH bi-directional white edge last 600 m yellow, End lights red
TWY	Green CL, blue edge lights and red stop bars

HS1, HS2, HS3, HS4, HS5, HS6- see backside of this page

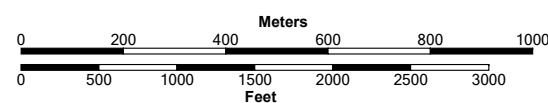

change: new holdspal 5, 6